

# Level One | Exhibit Halls

## Level One - Exhibit Space

- Exhibit Space
- Pre-function/Registration
- Show Offices
- Restaurant/Concessions
- Business Service Center
- FD** Freight Door
- FE** Freight Elevator
- PE** Passenger Elevator
- M** Men's Restroom
- W** Women's Restroom
- AG** All Gender Restroom
- E** Escalator
- G** Groundwork Coffee & Concessions
- A** ATM
- o Column
- + First Aid/Lactation Room

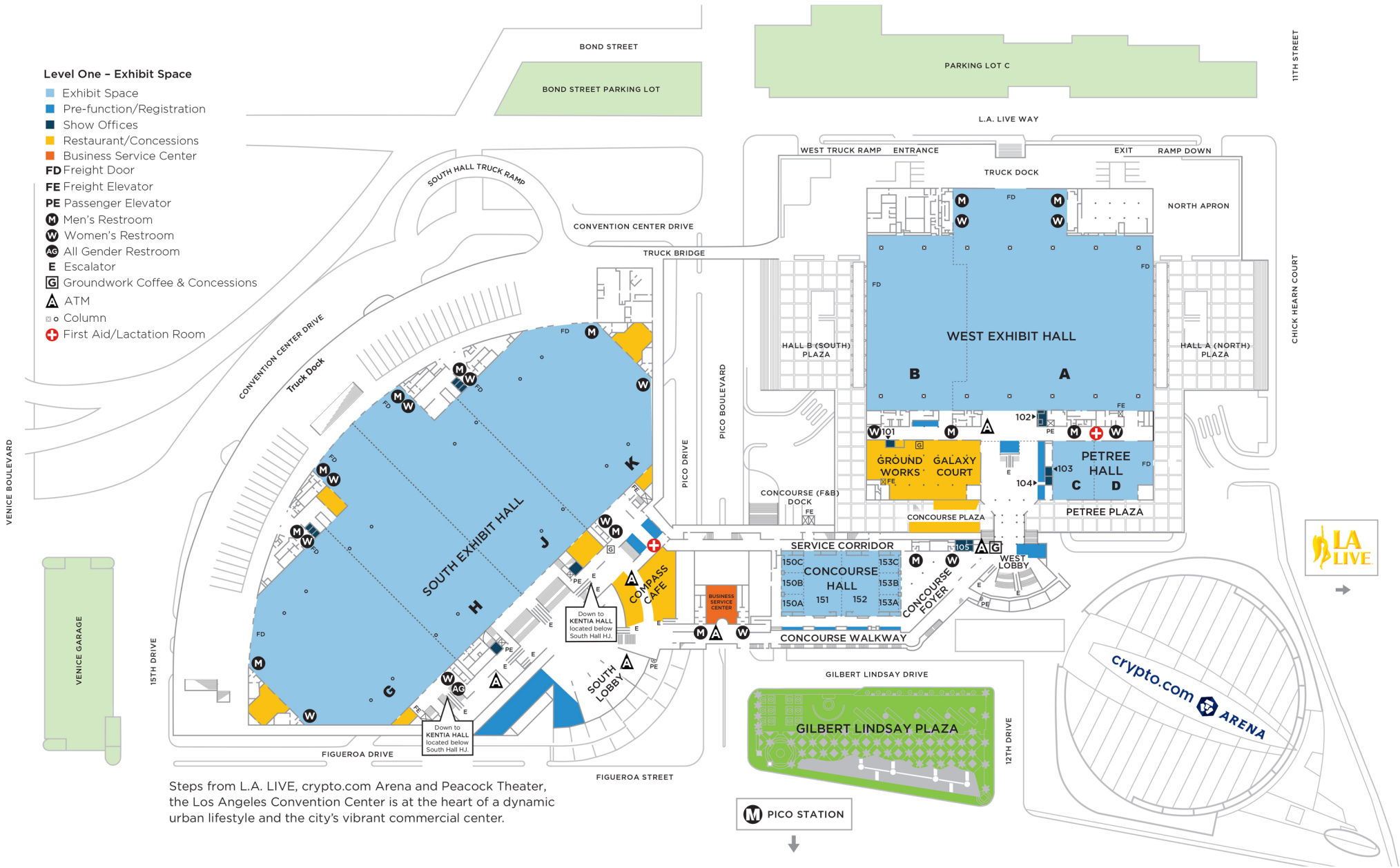

Steps from L.A. LIVE, crypto.com Arena and Peacock Theater, the Los Angeles Convention Center is at the heart of a dynamic urban lifestyle and the city's vibrant commercial center.

**M** PICO STATION



# LEVEL ONE & LOWER LEVEL - EXHIBIT HALLS

Maximum Capacity\*

West Hall	DIMENSIONS	SQUARE FEET	CEILING HEIGHT	10'X10'	THEATRE	CLASSROOM <sup>(a)</sup>	BANQUET <sup>(b)</sup>
A	342 x 363	147,506	36' <sup>**</sup>	715	10,000	‡	7,500
B	342 x 194	63,619	36' <sup>**</sup>	300	5,000	‡	2,500
AB combined	342 x 557	210,685	36' <sup>**</sup>	1,050	15,000	‡	10,000
Petree Hall	DIMENSIONS	SQUARE FEET	CEILING HEIGHT	10'X10'	THEATRE	CLASSROOM <sup>(a)</sup>	BANQUET <sup>(b)</sup>
C	83 x 114	9,462	17' <sup>***</sup>	45	1,010	500	470
D	111 x 114	11,926	17' <sup>***</sup>	60	1,200	600	500
CD combined	194 x 112	21,557	17' <sup>***</sup>	115	2,000	1,000	1,000
Concourse Hall	DIMENSIONS	SQUARE FEET	CEILING HEIGHT	10'X10'	THEATRE	CLASSROOM <sup>(a)</sup>	BANQUET <sup>(b)</sup>
150A or C, 153A or C	40 x 33	1,320	17'	‡	100	50	50
150B or 153B	40 x 42	1,680	17'	‡	140	100	60
150AB or BC, 153AB or BC	40 x 75	3,000	17'	‡	300	120	110
150ABC or 153ABC	40 x 109	4,360	17'	‡	360	220	180
151 or 152	74 x 117	8,658	17'	40	1,020	590	440
150 & 151 (Concourse E)	115 x 109/117	13,123	17'	65	1,500	830	675
151 & 152	148 x 117	17,316	17'	100	1,800	1,000	900
152 & 153 (Concourse F)	115 x 109/117	13,123	17'	65	1,500	830	675
150, 151, 152, 153 combined	230 x 109/117	26,342	17'	135	2,700	1,500	1,400
South Hall	DIMENSIONS	SQUARE FEET	CEILING HEIGHT	10'X10'	THEATRE	CLASSROOM <sup>(a)</sup>	BANQUET <sup>(b)</sup>
G	300 x 360	96,660	40'	490	6,300	‡	3,620
H	180 x 360/460	76,785	40'	420	‡	‡	‡
J	180 x 360/460	76,785	40'	420	‡	‡	‡
K	300 x 360	96,660	40'	490	6,300	‡	3,620
GH combined	480 x 360/460	173,445	40'	880	11,400	‡	6,400
HJ combined	360 x 360/460	153,570	40'	840	10,000	‡	5,400
JK combined	480 x 360/460	173,445	40'	880	11,400	‡	6,400
GHJ/HJK combined	600 x 360/460	250,230	40'	1,371	16,555	‡	8,000
GHJK combined	940 x 360/460	346,890	40'	1,720	22,870	‡	12,800

\* Capacities subject to change based on staging and audio-visual.

‡ Custom capacity based on Fire Marshal approval

<sup>(a)</sup> Classroom set based on four (4) per 8'x18" table

<sup>(b)</sup> Banquet set based on ten (10) per 66" round table.

\*\* 25' Soffit

\*\*\* 15' Soffit